

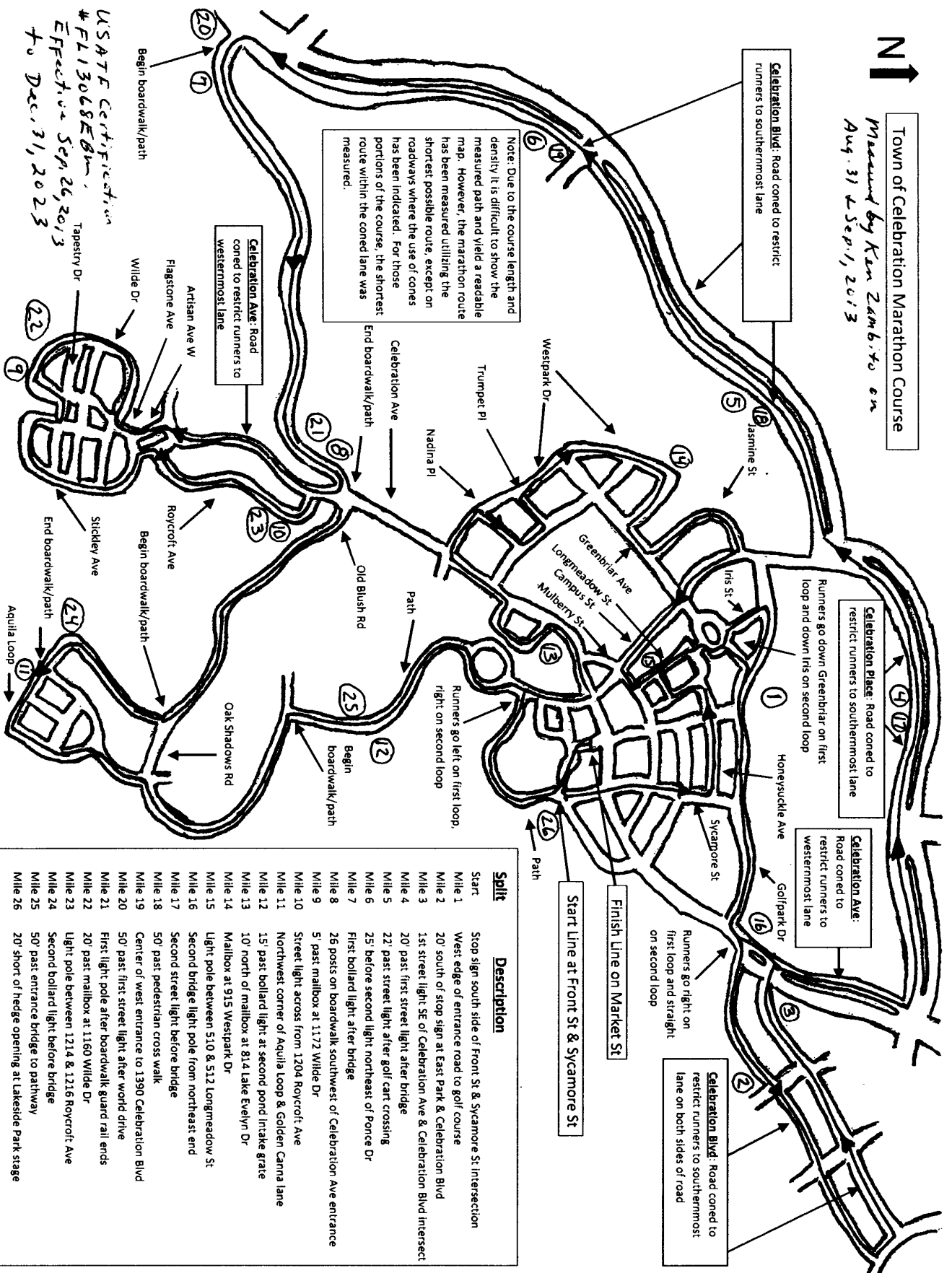

Town of Celebration Marathon Course

Measured by Ken Zambo, Esq.
Aug. 31 & Sep. 1, 2013



Note: Due to the course length and density it is difficult to show the measured path and yield a readable map. However, the marathon route has been measured utilizing the shortest possible route, except on roadways where the use of cones has been indicated. For those portions of the course, the shortest route within the coned lane was measured.

USATF Certification
#FL13068E8m
Effective Sep 26, 2013
to Dec 31, 2023

Split	Description
Start	Stop sign south side of Front St & Sycamore St intersection
Mile 1	West edge of entrance road to golf course
Mile 2	20' south of stop sign at East Park & Celebration Blvd
Mile 3	1st street light SE of Celebration Ave & Celebration Blvd intersect
Mile 4	20' past first street light after bridge
Mile 5	22' past street light after golf cart crossing
Mile 6	25' before second light northeast of Ponce Dr
Mile 7	First bollard light after bridge
Mile 8	26 posts on boardwalk southwest of Celebration Ave entrance
Mile 9	Street light across from 1204 Roycroft Ave
Mile 10	5' past mailbox at 1172 Wildie Dr
Mile 11	Northwest corner of Aquila Loop & Golden Carra lane
Mile 12	15' past bollard light at second pond intake grate
Mile 13	10' north of mailbox at 814 Lake Evelyn Dr
Mile 14	Mailbox at 915 Westpark Dr
Mile 15	Light pole between 510 & 512 Longmeadow St
Mile 16	Second bridge light pole from northeast end
Mile 17	Second street light before bridge
Mile 18	50' past pedestrian cross walk
Mile 19	Center of west entrance to 1390 Celebration Blvd
Mile 20	50' past first street light after world drive
Mile 21	First light pole after boardwalk guard rail ends
Mile 22	20' past mailbox at 1160 Wildie Dr
Mile 23	Light pole between 1214 & 1216 Roycroft Ave
Mile 24	Second bollard light before bridge
Mile 25	50' past entrance bridge to pathway
Mile 26	20' short of hedge opening at Lakeside Park stage